

# PRP Centrifuge





# REMI PRP Centrifuge

## REMI PRP Centrifuge

REMI is a leading name in India for Blood Bank & Laboratory equipment.

REMI is synonymous for centrifuge performance since year 1960. Our expertise in blood component separation brings the best solution - **PRP centrifuge** for low volume autologous PRP extraction within shortest possible time.

PRP Centrifuge brings automation & ease of operation with simple steps to separate the autologous PRP.

- Specially designed for PRP kits to ensure standard platelet property & standard platelet count
- Microprocessor controls on all run parameters (RPM/RCF, Acceleration, deceleration, time & temperature) for consistent high platelet's yield
- **Safety Features :**
- Door interlock, imbalance cut off, overload protection
- **Ease of Operation :** LCD display to select parameter, Feather touch Keypads
- **Dedicated preset button:** Programmed to pre-cool / run at recommended temperature for blood processing –
- Avoids Hemolysis (AABB manual\*)
  - F1 for pre-cool for keeping the centrifuge ready for separation
  - F2 for 1st spin for platelet separation
  - F3 for 2nd spin for platelet concentrate
- **Hygienic :** Easy to clean Stainless steel chamber
- **Stable :** Brushless induction drive motor (practically maintenance free)

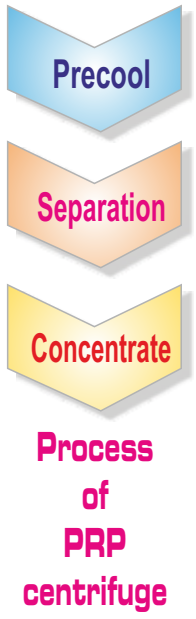

## DrPRP<sup>®</sup> - KIT

Dr.PRP is a medical device exclusively designed for autologous PRP separation. Highly concentrated platelets by the Dr.PRP kit release large amounts of growth factors which are normally inside the platelets.

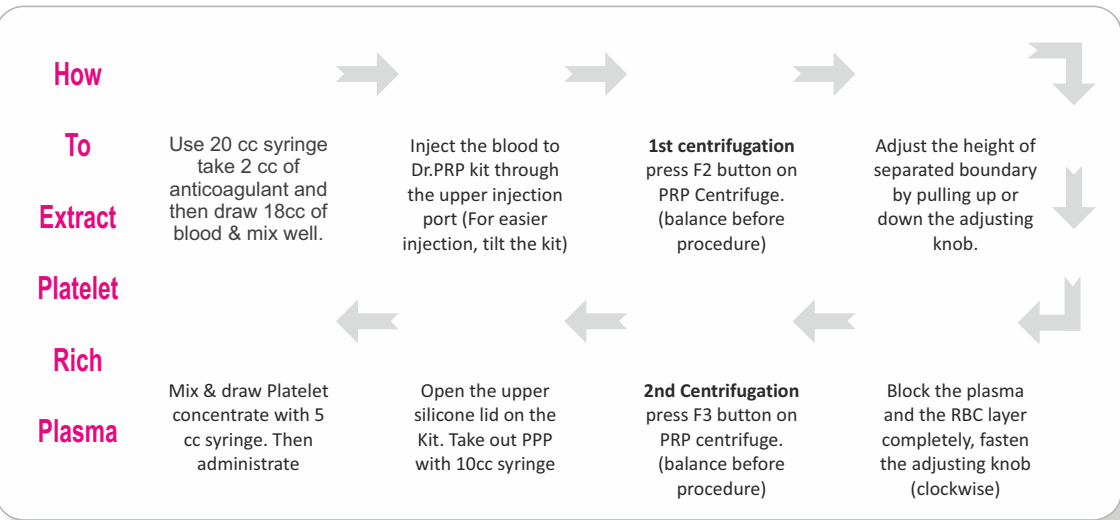

*(Dr. PRP Kit is a FDA approved product Imported from Korea)*



# REMI PRP Centrifuge



## PRP - Platelet Rich Plasma

The PRP therapy is gaining in popularity as single supportive treatment option for many indications. Autologous PRP contains different growth factors and other cytokines which may elicit gathering of stem cells around the damaged region stimulating cellular proliferation and tissue regeneration.

PRP contains growth factors that stimulate cellular growth and division.

- TGF-B (Transforming Growth Factor-beta)
- bGFG (Basic Fibroblast Growth Factor)
- PDGFa-b (Platelet Derived Growth Factor)
- EGF (Epidermal Growth Factor)
- VEGF (Vascular Endothelial Growth Factor)
- CTGF (Connective Tissue Growth Factor)

<p><b>PRP Advantage</b></p>	<p><b>Safe</b></p> <p>Using autologous blood means there is no risk of infection, allergic reaction, or any other side effect.</p>	<p><b>Convenient</b></p> <p>The treatment is quick and absolutely non-invasive.</p>	<p><b>Natural</b></p> <p>Patient feel no sense of violation by foreign bodies and the treatment effects are completely natural.</p>	<p><b>Effective</b></p> <p>Because the treatment uses growth factors, its effects are superior &amp; effective.</p>
-----------------------------	--	---	---	---

## Autologous Platelets: Effective but Delicate to Handle

- Vibration free centrifugation with right speed, time & temperature is important for intact biological properties
- Platelet's Processing & storing temperature at 22°C is important ..... *\*AABB Technical Manual 18th Edition*
- Cooling centrifuge saves platelets from the effect of heat generated during centrifugation..... *\*\*Blood Vol 32, No.2 (August), 1998*

	<p>Keep blood at room temperature (20 to 24 C) before separating platelet-rich plasma from the red cells. This separation must take place within 8 hours of phlebotomy.</p> <p><i>* Method 6.13. Preparation of Platelets from Whole Blood; AABB Technical Manual 18th Edition</i></p>	<p>Heat induced loss of functional capacity is due to irreversible structural changes in platelets develop after warming PRP above 40°C. Heat produced a distinct morphological transformation characterized by loss of discoid shape, irregular swelling, and movement of hyaloplasmic organelles.</p> <p><i>** Effect of heat on platelet structure and function; Dr James G. White; Blood, Vol.32, No. 2 (August), 1998</i></p>	
--	--	--	--

Specifications subject to change without notice



# PRP Centrifuge



Technical Data	
	PRP Plus
Max. Tube Size (ml)	20
Max. Capacity (ml)	80
*Min. Temperature (°C)	22
Dimensions WxDxH (mm)	480 x 585 x 530
Noise Level	≤ 58 (dB)
Voltage Stabilizers	VS - 02
Supply: 220-240 Volts 50 Hz single Phase	

\* **Note : Depending on capacity, type of rotor centrifugation speed, ambient temperatures and other process parameters.**



## Corporate Marketing Office REMI SALES & ENGINEERING LTD.

Remi House, 3rd floor, 11, Cama Industrial Estate, Walbhat Road, Goregaon (East), Mumbai - 400 063. INDIA.  
Tel: +91 22 4058 9887 / 26851998 Fax: +91 22 40589890 E-mail: sales@remilabworld.com Website: www.remilabworld.com

### BRANCHES

#### AHMEDABAD

Tel.: +91 79 2640 3235, 3294 2703  
Fax: +91 79 2646 4081  
E-mail: instrumentahmd@remigroup.com

#### GOA

Tel.: +91 832 271 3671  
E-mail: goa@remigroup.com

#### INDORE

Tel No.: 0731-3299606  
E-mail: indore@remilabworld.com

#### KOCHI

Tel.: +91 484 231 6938, 231 6595  
Fax: +91 484 232 0468  
E-mail: info@inlabinstruments.com

#### BENGALURU

Tel.: +91 80 2222 4406, 2222 4423,  
E-mail: instrumentbang@remigroup.com

#### KANPUR

Tel.: +91 512 325 8726  
E-mail: kanpur@remigroup.com

#### NAGPUR

Tel.: +91 712 244 3077, 301 3416  
Fax: +91 712 244 8156  
E-mail: remisalesngp@gmail.com

#### CHENNAI

Tel.: +91 44 2851 8622, 2854 6356,  
3295 1155 Fax: +91 44 2841 1952  
E-mail: instrumentchennai@remigroup.com

#### HYDERABAD

Tel.: +9140 2754 6291, 2753 0217,  
3294 7135 Fax: +91 40 2754 2646  
E-mail: instrumenthyd@remigroup.com

#### KOLKATA

Tel.: (033) 2211 6367, 3295 0245,  
32567745/46 Fax: (033) 2211 7221  
E-mail: instrumentkolkata@remigroup.com

#### NEW DELHI

Tel.: +91 011 2850 2666, 3250 2288  
Fax: +91 011 2557 3170  
E-mail: instrumentdelhi@remigroup.com

#### MUMBAI

Tel.: +91 22 4058 9887, 26851998  
Fax: +91 22 4058 9890  
E-mail: sales@remilabworld.com

Specifications subject to change without notice

